

TECHNICAL NOTE

TAUROA RESIDENTIAL SUBDIVISION: LANDSLIDE REMEDIATION AND HILL SLOPE STABILISATION FOR EARTHQUAKE RESISTANCE

Riley C. Gerbrandt¹

SUMMARY

The Tauroa residential subdivision is situated in the hills of southern Havelock North in Hawke's Bay, New Zealand. The development proposal includes removal of a moderately deep (<10 m) landslide and its replacement with an engineered fill slope. A simplified "screening analysis" method was utilised to develop reduced equivalent horizontal seismic loads for use in a pseudo-static slope stability assessment of the proposed remedial engineered fill slope. This risk-based method allows limited slope deformations to occur as a result of the design seismic event, with the magnitudes of the allowable slope deformations set in accordance with the tolerance level of the proposed development.

INTRODUCTION

Geologically, some of the more significant aspects of the hills to the south of Havelock North, New Zealand include the moderately deep to deeply seated landslides within the Kidnappers Group strata. Many landslides are visible in this area and these can pose risks to nearby development. Assessment of the engineering stability of these landslides and of unfailed slopes in similar conditions is complex.

Stage 7 of the Tauroa residential subdivision is currently ongoing, and the assessment of the stability of an engineered fill slope proposed at the site of an existing moderately deep (< 10 m) landslide was required. The assessment and design incorporated previous work as well as additional geotechnical investigations that were conducted during detailed design.

SITE LOCATION AND DESCRIPTION

The Tauroa subdivision is located at the southern end of the Havelock North township in the Hawke's Bay region of New Zealand. Stage 7 of the subdivision comprises approximately 10 ha of generally hilly terrain between Tauroa Road and the Mangarau stream. Several incised gullies and two significant landslides are located within the area. The larger landslide ("Landslide 1") is approximately 7 ha in size and abuts the site to the northwest. The smaller landslide ("Landslide 2", hereafter referred to as *LS2*) is located in the northern half of

the site and is approximately 0.2 ha in size. The hills are moderately steep, with slope angles generally of the order of 12 to 20 degrees to the horizontal, and are dissected by the gullies. Refer to Figure 1 for the locations of these landslides and for a presentation of the site topography in relation to the development proposal.

DEVELOPMENT PROPOSAL

The development proposal for Stage 7 of the Tauroa subdivision includes subdividing the property in order to construct 12 new residential building platforms and associated infrastructure. Due to the hilly nature of the existing site topography, some moderately significant earthworks will be carried out to form the roads and building platforms. During the initial stages of the project development, it was proposed to leave *LS2* largely untouched. During the detailed design phase of the project, however, the design was altered to include removing *LS2* and replacing it with an engineered fill slope. This design change allowed for a more stable road alignment, the construction of an access road for Lot 12 on top of *LS2* and the formation of more robust building platforms on Lots 3 and 7. Refer to Figure 2 for the current development proposal.

¹ *Opus International Consultants, Ltd, New Zealand.*

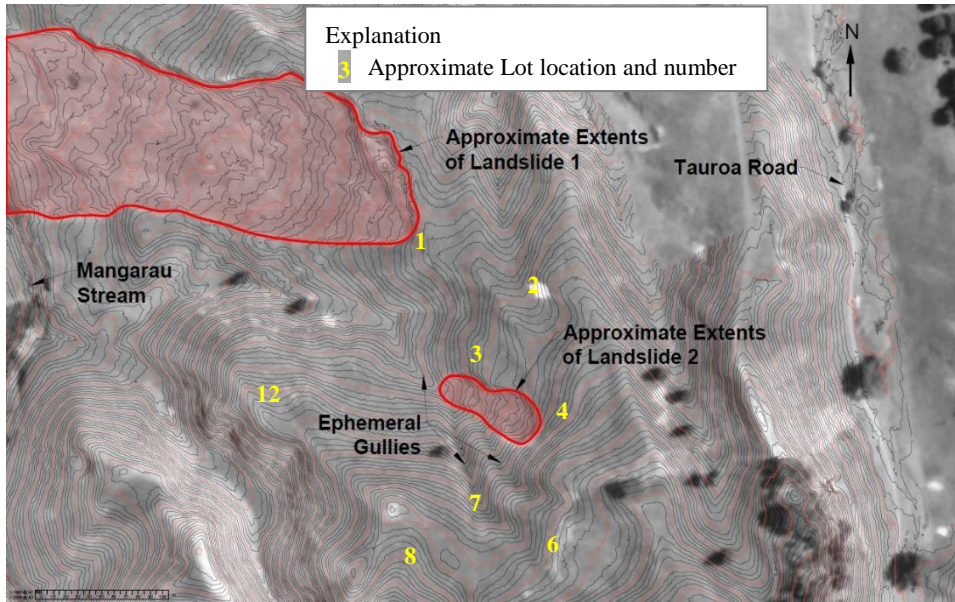

Figure 1: LiDAR topography of site on 1950 aerial photograph and showing key features within the vicinity.

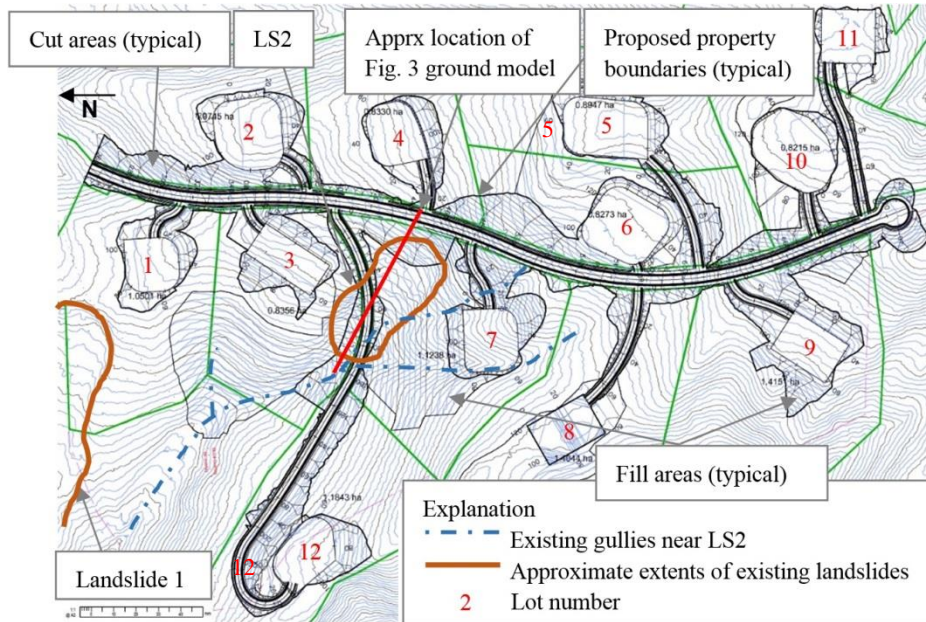

Figure 2: Tauroa residential subdivision, Stage 7 development proposal.

GEOLOGIC SETTING

Geology of the Area

Tauroa subdivision is located within the western extreme of the forearc basin structural high that is associated with the Australian-Pacific plate margin. From the Miocene epoch through the middle Pleistocene epoch, the area was subjected to cyclic sea inundation and emergence as a result of tectonic movements and glacial periods [1]. During periods in which the land was submerged, sediments were deposited within the epeiric shelf [2]. The sedimentation thus principally resulted in the formation of mudstone, limestone and conglomerate rocks that were deposited within a shallow sea environment. Since the mid Pleistocene, the area has been above sea level, and the present drainage patterns were established [1].

In the area of LS2, the rock strata comprise calcareous sandstones overlain by Kidnappers Group estuarine mudstone

that dip approximately 10 to 15 degrees to the west-northwest. The presence of layered carbonaceous materials (derived from vegetation) within the mud may provide low-strength layers on which slope movement can occur [3]. These strata are overlain by interbedded volcanic tephra (typically fine pumiceous sands) and wind-deposited glacial loess silts, the most recent of which is typically 2 to 3 m thick and often contains an approximately 1 m thick cemented fragipan [3].

Seismic History

The Hawke’s Bay region is one of the most earthquake prone in New Zealand. Oblique subduction of the Pacific plate beneath the Australian plate dominates the tectonic activity of the region, which hosts a minimum of 22 known active faults and folds that are capable of producing very strong earthquake shaking. The Hawke’s Bay region has experienced strong earthquake shaking (i.e. maximum felt intensities of ≥ 7 on the Modified Mercalli Intensity scale) on at least 19 occasions during the last approximately 150 years [2]. As required by the

New Zealand Building Code and NZS 1170.5:2004, earthquake shaking must be considered when assessing the slope stability hazard of developments.

Description of LS2

LS2 is a moderately deep (<10 m) landslide characterised by classic translational movement within a locally weak layer of the estuarine mudstone. The triggering mechanisms of similar, but larger, translational and deep-seated landslides some 500 and 150 m to the northeast are likely attributed to a combination of rainfall infiltration and of downcutting and lateral erosion of the toe by the Mangarau stream [3, 4]. Seismic movement may also be a contributing factor. Due to the presence of two drainage gullies near the toe of LS2, it can be postulated that the failure may have been triggered by a similar combination of factors.

PREVIOUS WORKS

1991 Work by Bell [3]

Bell [3] published the initial Tauroa subdivision work in 1991. He mapped numerous landslide features and, utilising tephra and pumice markers as well as aerial photo interpretation, dated two secondary slide failures as having occurred between approximately 1800 and 100 years before present (BP). Bell [3] focused considerable attention on the Goat Shed Slide, which is located approximately 500 m northwest of LS2. Several polished and/or slickensided surfaces were identified within borehole cores and were logged as failure surfaces, with the failure planes dipping approximately six degrees to the west. Samples of these failure surfaces were tested in the laboratory and returned average residual soil strength parameters of $c_r = 5$ kPa and $\phi_r = 11$ degrees. A separate un-failed estuarine mudstone sampled from an adjacent borehole returned $c_r = 6$ kPa and $\phi_r = 16$ degrees.

Works by Gray and Jowett [4] and Gray and Watson [5]

The subject property was first studied in the preliminary geotechnical appraisal [4], and it was later assessed in more detail in a preliminary geotechnical report [5]. Subsoil investigations identified the failure plane near the centre of LS2 at approximately 6.65 to 6.90 m below the existing ground surface. Groundwater was not encountered in an exploratory borehole that extended to a depth of 15.45 m below the existing ground surface.

ASSESSMENT OF THE STABILITY OF LS2

New Geotechnical Investigations

As discussed previously in this paper, changes were made to the site development proposal between the publication of the referenced preliminary geotechnical report and commencement of the detailed design phase. These changes included remediation of LS2 by undercutting and removing the landslide debris and replacing it with an engineered fill to improve its stability. In order to design the remedial works and the engineered fill, additional geotechnical site investigation and laboratory testing was required.

Overview of Ground Conditions

Three mechanically excavated test pits (TPs) were conducted

at the site during September 2013. These TPs exposed the near-surface soils within the study area. In general, near-surface loess SILT was encountered interbedded with pumice sand; a cemented fragipan ("hardpan") was generally encountered between 1.0 and 1.5 m below the existing ground surface. Stiff Silty CLAY colluvium (i.e. landslide material) was encountered within LS2 overlying undisturbed very stiff to hard estuarine mud deposits; a potential slickensided slip surface was encountered at the interface of the colluvium and the estuarine mud deposits at 2.4 m below the existing ground surface.

Samples retrieved during the September 2013 geotechnical site investigation were tested in an Opus IANZ accredited soil laboratory. In order to evaluate the soil strength parameters for the proposed engineered fill, consolidated drained direct shear tests were conducted on remoulded samples of the bulk soils. Moreover, a three-stage consolidated undrained triaxial compression test with pore pressure recording was conducted on push tube samples of the estuarine mud deposits to evaluate its in-situ soil strength parameters. A sensitivity analysis was conducted utilising the laboratory test results to develop design ϕ' and c' values for the project. Design ϕ' and c' values of 28 degrees and 15 kPa, respectively, were adopted for the Sandy SILT (engineered fill), while design ϕ' and c' values of 23 degrees and 9 kPa, respectively, were adopted for the in-situ stiff clayey SILT.

Slope Stability Assessment

The geotechnical data was used to prepare an interpretive sub-surface ground model for the proposed engineered fill. Refer to Figure 3 for the presentation of this interpretive ground model, which formed the basis of the slope stability assessments. The slope stability assessments were conducted using the computer programme SLOPE/W [6]. In accordance with the local Engineering Code of Practice [7] and standard engineering practice for slopes that provide integral support for or direct loading on a structure, target factors of safety (FS) against failure of 1.5, 1.2 and 1.0 were established for static, transient seepage and seismic loading conditions, respectively.

Both circular and block-specified failure surfaces were analysed. The Morgenstern-Price method of slices was utilised to determine the FS for each failure surface. Groundwater was modelled within SLOPE/W using a phreatic surface(s) that, depending on the condition modelled, was either constrained to a certain (or several certain) strata or was unconstrained.

The development proposal includes a road above the engineered fill, an access road for Lot 12 down the face of the engineered fill and a residential building platform within the southern portion of the engineered fill. Therefore, critical case vehicle and building loads were applied as appropriate.

The development proposal includes complete removal of the landslide colluvium, benching of the excavation surface to a depth below the current slip surface, and the formation of keyways prior to the construction of the proposed LS2 engineered fill slope. Subsoil drains are to be constructed within the benches, keyways and gully areas to drain the area and keep the proposed engineered fill slope from becoming saturated. A quality assurance and construction monitoring programme was adopted to ensure that the design compaction specification would be achieved. Four cross-sections of the LS2 engineered fill slope model were assessed: two down its length (in profile) and two across its width.

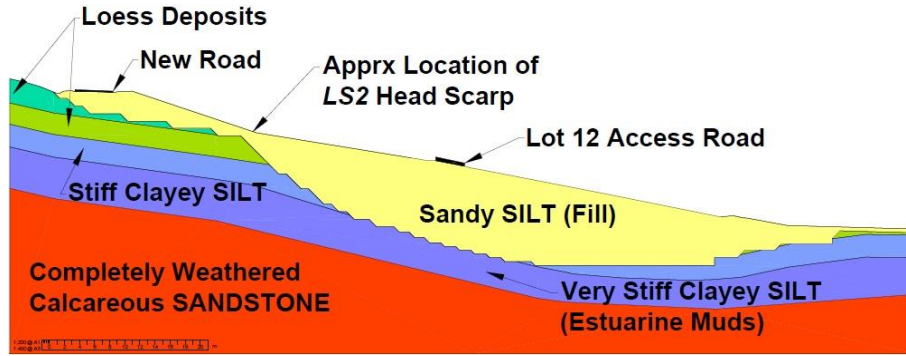

Figure 3: LS2 ground model for SLOPE/W (refer to Fig. 2 for location).

Static Slope Stability Analysis

Geotechnical soil properties were assigned to the interpretive ground model strata using the results of the laboratory test data and experience with similar soils in similar geological conditions. Whilst groundwater was not encountered in the referenced site investigations, a prevailing groundwater surface was assumed at the interface of the completely weathered SANDSTONE and the clayey SILT.

Transient Seepage Slope Stability Analysis

The transient seepage condition was modelled first utilising an elevated groundwater level (i.e. phreatic surface) applied above the prevailing typical groundwater table. This surface was applied to all soil types. As the presence of groundwater perched above the fragipan is believed to have caused many of the numerous shallow surface failures observed within the Tauroa subdivision [3], the transient seepage condition was secondly modelled utilising the elevated phreatic surface (as above) in conjunction with a phreatic surface perched above the fragipan in the natural soils. Thirdly, failure of the slope subsoil drains was also modelled by applying the elevated phreatic surface in conjunction with a phreatic surface located within the near-surface Sandy SILT loess and perched above both the natural fragipan and the engineered fill.

Dynamic (Seismic) Slope Stability Analysis

Methodology

Due to the absence of loose, saturated sandy soils and sensitive fine-grained soils at the site, the site was not considered to be susceptible to a liquefaction-induced flow failure. Therefore, assessment of the inertial seismic stability of the proposed engineered fill slope utilising the pseudo-static method (refer to [8-12]) was considered appropriate.

In the pseudo-static method, an equivalent horizontal seismic load (k_{eq}) is applied to the slope to approximate earthquake shaking. Depending on which variant of the method is applied, k_{eq} is either equal to a specific acceleration (e.g. 0.1g, 0.15g, 0.20g) or is equal to the peak ground acceleration (PGA) multiplied by a site seismicity factor (f_{eq}). The pseudo-static method can be further utilised to estimate the Newmark-type sliding block displacement [13] resulting from the design seismic event.

As an alternative to conducting a Newmark-type displacement analysis of the slope, a simplified screen analysis procedure was adopted. In such “screening analysis” slope stability assessments, slopes that meet or exceed the project’s target FS are considered stable. For slopes that return a value less than

the project’s target FS , then a Newmark-type analysis (or similar) should be conducted utilising the maximum design seismic load (k_{max}) to estimate the slope displacements that are likely to result from a design seismic event [14]. Therefore, provided the slope stability assessment of the proposed engineered fill slope returned a FS that meets or exceeds the target FS , the “screen analysis procedure” is considered an acceptable method to assess the seismic stability of the proposed engineered fill slope.

In the absence of specific guidance on the use of the simplified screen analysis procedure within New Zealand, the “screen analysis procedure” presented in SP117A [15] was utilised as a best practice basis for which to develop appropriate f_{eq} values. This method was formulated to identify geographic areas that are potentially susceptible to earthquake-induced landslides [14, 16]. The Stewart, *et al* [14] equation for f_{eq} is

$$f_{eq} = \frac{NRF}{3.477} \times \left[1.87 - \log_{10} \left(\frac{u}{(MHA_r/g) \times NRF \times D_{5-95,m}} \right) \right] \quad (1)$$

where MHA_r/g = maximum horizontal acceleration of base rock; NRF = nonlinear response factor to correlate MHA_r/g to the spatially averaged peak amplitude of shaking within the soil slide mass (since earthquake shaking is often amplified or de-amplified by the soil overlying the bedrock); u = 5 or 15 cm; and $D_{5-95,m}$ = median duration of earthquake shaking derived from Abrahamson and Silva [17] relationship.

Stewart, *et al* [14] provide the following equation for NRF , which is reproduced therein from Bray and Rathje [18]:

$$NRF \approx 0.622 + 0.92 \times e^{(-2.25 \times MHA_r/g)} \quad (2)$$

for $0.1 < MHA_r/g < 0.8$

The equation for $D_{5-95,m}$ is also provided by Stewart, *et al* [14]:

$$\ln(D_{5-95,m}) = \ln \left[\frac{\left(\frac{e^{[5.204 + 0.851(M-6)]}}{10^{1.5M + 16.05}} \right)^{-\frac{1}{3}}}{15.7 \times 10^6} + 0.063(r-10) \right] + 0.8664 \quad (3a)$$

for $r > 10$ km

$$\ln(D_{5-95,m}) = \ln \left[\frac{\left(\frac{e^{[5.204+0.851(M-6)]}}{10^{1.5M+16.05}} \right)^{\frac{1}{3}}}{15.7 \times 10^6} \right] + 0.8664$$

for $r < 10 \text{ km}$ (3b)

Equations 3a and 3b require values for the expected magnitude (M) and the distance to the source (r). A 7.5 M event on either the Poukawa fault zone or the Mohaka fault is considered the likely design event for the [19-21], so worst-case values of 7.5 for M and 48 km for r were utilised to calculate f_{eq} .

Calculation of k_{eq}

For the analysis, the PGA was calculated utilising NZS 1170:2002 for residential dwellings with a 50-year design life and a Site Subsoil Class of Class C (“Shallow Soil”). MHA_r in Equation 1 was set equivalent to PGAs determined by application of NZS 1170 for Site Subsoil Class C, rather than for Site Subsoil Class A or B. This was done to provide appropriate conservatism consistent with the nature of the development proposal. Therefore, for this study a PGA of 0.52g was determined for the ultimate limit state (ULS) condition, which corresponds to a 500-year return period.

Using Equation 1, f_{eq} values of 0.60 and 0.47 were returned for these respective situations: maximum slope displacements of less than 50 mm for slopes providing integral support of a building platform, and maximum slope displacements of less than 150 mm for slopes not providing integral support of a building platform. These threshold displacements are presented within the “screen analysis procedure” methodology and reflect the fact that landslides are capable of accommodating a limited amount of displacement (i.e. partial mobilisation) before complete mobilisation of the basal rupture surface and catastrophic ground failure occurs [22]. Multiplying the PGA by the f_{eq} values produced k_{eq} values of 0.31g and 0.25g for use in the analyses for allowable deformations of 50 and 150 mm, respectively.

In accordance with this methodology, a project provision was adopted requiring that buildings to be constructed at the site and integrally supported by the proposed engineered fill slope be designed to tolerate ULS slope displacements of up to 50 mm whilst remaining in accordance with the New Zealand Building Code.

Slip Surface Location and Modelled Soil Strengths

It was assumed that the location of the seismic condition slip surface is generally consistent with the location of the corresponding static condition slip surface. As earthquake loadings are generally applied so rapidly that all but the most permeable of soils (e.g. coarse gravels and/or cobbles) are loaded in an undrained manner [10, 23, 24], it was assumed that the sub-surface soils at the site will not drain appreciably during earthquake loading. Thus, undrained shear strengths were used within the SLOPE/W analyses by utilising the programme’s Mohr-Coulomb soil strength setting together with its option to keep the slice base shear strength unaltered when the dynamic force is applied. The accuracy of this option within SLOPE/W was tested on a homogenous slope model comprising numerous thin horizontal soil strata, and the option was found to be sufficiently accurate for the intended purpose.

Lastly, it is widely accepted that degradation of soil strength occurs during the dynamic (e.g. earthquake) loading of a slope [10, 11, 22-25] and that a “dynamic yield strength” may be utilised to represent such strength degradation when complete mobilisation of the basal rupture surface does not occur [10, 25]. As modelling the slope utilising soil “dynamic yield strengths” would require lengthy iterative computations, the author elected to increase the seismic condition target FS from 1.0 to 1.2 to allow for soil dynamic strength degradation.

Summary of Stability Analyses and Design of Slope Surface

Save for the failure surfaces initiating from the north-western half of the Lot 7 building platform and extending north across the engineered fill slope, the FS values returned from the slope stability analyses all met or exceeded the target FS values.

The failure surfaces initiating from the north-western half of the Lot 7 building platform returned FS values less than 1.2 for a k_{eq} of 0.31g. In order to mitigate the potential for a slope failure resulting in moderate displacements, the access road for Lot 12 was shifted slightly north and the toe elevation at this location was raised by 2 m. When re-assessed, these changes resulted in slope stability FS values that exceeded 1.2.

DESIGN OF REMEDIATION PROGRAMME FOR LS2

The remedial design includes undercutting and removing the existing LS2 colluvium to expose undisturbed deposits, forming keyways and benches with subsoil drainage, placing controlled engineered sandy SILT fill in 0.2 m (compacted) lifts and forming a new ground surface. A cut-fill building platform is to be constructed for Lot 7 at the top of the engineered fill slope, and a buttress fill of approximately 2 m in height is to be constructed at the toe and along the lower face of the slope to the north (below Lot 3) of LS2.

Control of both surface water and subsoil seepage is considered critical to the success of the LS2 remedial works. Therefore, the remedial design also includes pavement cut-off drains along both the new roadway and the Lot 12 access road as well as subsoil drains placed within the gullies and seepage areas to the south and west of LS2. The subsoil drains are to discharge via solid pipes to the stormwater detention dam to be constructed approximately 100 m northwest of the existing LS2 toe. Surface water control is to be provided by drainage swales along the uphill side of the Lot 12 access road, around the back and eastern side of the Lot 7 building platform and along the uphill (eastern) side of the main subdivision road; the road is immediately east of the existing LS2 head scarp. These drainage swales are to be designed discharge to the reticulated stormwater system beneath the new road whilst limiting the potential for water to infiltrate from the swale surfaces into the engineered fill.

The sandy SILT material for use as engineered fill is to be sourced from borrow areas within the subdivision. The earthworks specification produced for the works provides appropriately stringent materials testing and compaction controls for the works. In addition to including material requirements for the bulk fill, the document specifies minimum values and testing frequency for bulk fill air voids, water content, material relative density and undrained shear strength. Monitoring of the fill-induced settlements of the subsoils and engineered fill is planned during placement of the engineered fill. Settlement monitoring is to continue after completion of the works and until at least 90 per cent of the settlement has occurred. Quality assurance testing and

engineer observation is also specified so that a geotechnical completion report can be prepared following completion of the works.

The proposed works have currently been initiated and the area of LS2 has been cleared and stripped. Subsoil drains have been installed within several of the ephemeral gullies near LS2 and a keyway has been cut into competent undisturbed materials near the toe of LS2. The landslide colluvium has been undercut and removed, and benches have been prepared within the underlying mud deposits. Much of the engineered fill has been placed under the supervision of the author, but the final ground surface has not yet been formed.

CONCLUSIONS

The seismic design of the remedial engineered fill slope, which is to replace LS2 at Tauroa subdivision, employed the pseudo-static analysis method with k_{eq} determined utilising the simplified “seismic screening analysis” [14]. Allowable slope displacement thresholds were adopted to reflect that landslides are capable of accommodating a limited amount of displacement before complete mobilisation of the basal rupture surface and catastrophic ground failure occurs [22]. Displacement thresholds consistent with the Stewart, *et al* [14] method and appropriate for the importance level of each portion of the engineered fill slope were adopted for this study. The resulting remedial design and construction programme is within the bounds of normally accepted earthworks programmes for similar development proposals, and the risk level is considered appropriate to the importance level of the proposed structures. Therefore, the analyses and remedial design approaches described in this paper can find useful application in similar hillside developments within New Zealand where the subsoils are not considered susceptible to weakening instabilities (e.g. flow liquefaction and cyclic mobility) and where brittle rock slope failures are not anticipated.

ACKNOWLEDGEMENTS

The author thanks Hamish McHardy, the owner of the Tauroa subdivision property, for his permission to prepare this paper. He also thanks Inoannis Antonopoulos for his assistance in interpreting the triaxial compression test results as well as William Gray, Keith Nicholls and Pathmanathan Brabharan for their review of the manuscript and provision of many helpful comments.

REFERENCES

- Kingma, J.T. (1971). “*Geology of the Te Aute Subdivision*”. New Zealand Geological Survey, Bulletin n.s. 70.
- Begg, J.G., Hull, A.G. and Downes, G.L. (1994). “*Earthquake Hazards in Hawke’s Bay: Initial Assessment*”. Institute of Geological & Nuclear Sciences Ltd, Client Report 333901.10.
- Bell, D.H. (1991). “*Engineering Geology Report on Proposed Tauroa Subdivision – Havelock North*”. University of Canterbury, Christchurch, New Zealand.
- Gray, W. and Jowett, T. (1998). “*Tauroa Subdivision, Rural 5 Extension, Preliminary Geotechnical Appraisal*”. Opus International Consultants Ltd., Opus Reference 2S0602.00/98/1.
- Gray, W. and Watson, J. (2012). “*Tauroa Subdivision, Stage 7*”. Preliminary Geotechnical Report for Raumatī Trust, Opus International Consultants Ltd., Opus Reference G3003, 2-S0602.00. Issue 1.
- GEO-SLOPE International, Ltd. (2012). “SLOPE/W by GeoStudio”. July 2012 release. Version 8.0.7.6129.
- Hastings District Council. (2011). “*Engineering Code of Practice*”.
- Terzaghi, K. (1950). “Mechanism of Landslides”. In *Applications of Geology to Engineering Practice*, Geological Society of America, Berkley, pp. 83-123.
- Seed, H.B. and Martin, G.R. (1966). “The Seismic Coefficient in Earth Dam Design”. *Journal of Soil Mechanics and Foundations Division* **92**: (Proc. Paper 4824).
- Seed, H.B. (1979). “Considerations in the Earthquake Resistant Design of Earth and Rockfill Dams”. *Geotechnique* **29**(3):215-263.
- Makdisi, F.I. and Seed, H.B. (1979). “Simplified Procedure for Estimating Dam and Embankment Earthquake-Induced Deformations”. *ASCE Journal of the Geotechnical Engineering Division* **104**(GT7):846-867.
- Hynes-Griffin, M.E. and Franklin, A.G. (1984). “*Rationalizing the Seismic Coefficient Method*”. Department of the Army, Waterways Experiment Station, Corps of Engineers. Miscellaneous Paper GL-84-13.
- Newmark, N.M. (1965). “Effects of Earthquakes on Dams and Embankments”. *Geotechnique* **15**:139-160.
- Stewart, J.P., Blake, T.F. and Hollingsworth, R.A. (2003). “A Screen Analysis Procedure for Seismic Slope Stability”. *Earthquake Spectra* **19**(3): 697-712.
- California Geological Survey. (2008). “*Guidelines for Evaluating and Mitigating Seismic Hazards in California*”, Special Publication 117A.
- Blake, T.F., Hollingsworth, R.A. and Stewart, J.P. (2002). “*Recommended Procedures for Implementation of DMG*”. Special Publication 117: Guidelines for Analysing and Mitigating Landslide Hazards in California. SCEC.
- Abrahamson, N.A. and Silva, W.J. (1996). “*Empirical Ground Motion Models*”. Report prepared for Brookhaven National Laboratory, New York, New York, May, 144 pp.
- Bray, J.D. and Rathje, E.M. (1998). “Earthquake-induced displacements of solid-waste landfills”. *ASCE Journal of Geotechnical and Geoenvironmental Engineering* **124**(3): 242-253.
- Berryman, K., McVerry, G. and Villamor, P. (1997). “*Hawke’s Bay Region Earthquake Hazard Analysis Programme, Stage 2: A Numerical Assessment of the Earthquake Hazard in the Hawke’s Bay Region*”. Prepared for Hawke’s Bay Regional Council by Institute of Geological and Nuclear Sciences. Client Report 33591D.
- Hengesh, J.V. (1998). “*Hawke’s Bay Regional Council Earthquake Hazard Analysis: Stage III – Evaluation of Ground Shaking Amplification Potential Vol 1*”. Prepared for Hawke’s Bay Regional Council by Institute of Geological and Nuclear Sciences. Client Report 40652B.
- Hawke’s Bay Regional Council. (2001). “*Engineering Lifelines Project. Facing the Risks*”. Plan No. 3065.
- Murphy, W. and Mankelov, J.M. (2004). “Obtaining

- Probabilistic Estimates of Displacement on Landsliding during Future Earthquakes”, *Journal of Earthquake Engineering* **8**(1): 133-157.
- 23 Kramer, S.L. (1996). “*Geotechnical Earthquake Engineering. Upper Saddle River*”. Prentice-Hall Inc., New Jersey.
- 24 Duncan, J.M. and Wright, S.G. (2002). “*Soil Strength and Slope Stability*”. John Wiley & Sons Inc., Hoboken, New Jersey.
- 25 Makdisi, F.I. and Seed, H.B. (1977). “*A Simplified Procedure for Estimating Earthquake-Induced Deformations in Dams and Embankments*”. Earthquake Engineering Research Center Report UCB/EERC-77/19.